

**IFT245**

IFK3006-BPKG/AM/P/US-104-DPS

**Inductive sensors**

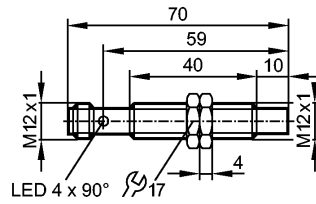

Made in Germany



**Product characteristics**

Inductive sensor
Metal thread M12 x 1
Connector
Full metal housing
Increased sensing range
Gold-plated contacts
Sensing range 6 mm; [nf] non-flush mountable

**Electrical data**

Electrical design	DC PNP
Operating voltage [V]	10...36 DC
Current consumption [mA]	< 25
Protection class	III
Reverse polarity protection	yes

**Outputs**

Output function	normally open
Voltage drop [V]	< 2.5
Leakage current [mA]	< 0.1
Current rating [mA]	100
Short-circuit protection	pulsed
Overload protection	yes
Switching frequency [Hz]	500

**Range**

Sensing range [mm]	6
Real sensing range (Sr) [mm]	6 ± 10 %
Operating distance [mm]	0...4.9

**Accuracy / deviations**

Correction factors	mild steel = 1 / stainless steel = 1 / brass approx. 0.9 / aluminium approx. 0.75 / copper approx. 0.6
Hysteresis [% of Sr]	1...20
Switch-point drift [% of Sr]	-10...10

**Environment**

Pressure rating [bar]	100; *)
Ambient temperature [°C]	0...100
Protection	IP 65 / IP 67 / IP 68 / IP 69K

**Tests / approvals**

EMC	EN 61000-4-2 ESD: 4 kV CD / 8 kV AD
	EN 61000-4-3 HF radiated: 10 V/m (80...2000 MHz)

**IFT245**

IFK3006-BPKG/AM/P/US-104-DPS

**Inductive sensors**

	EN 61000-4-4 Burst:	2 kV
	EN 61000-4-6 HF conducted:	10 V (0.15...80 MHz)
	EN 55011 (Emission):	class B
Impact resistance	DIN EN 60068-2-75 Ehc:	1 J
MTTF [Years]		810

**Mechanical data**

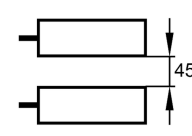
Mounting	non-flush mountable	
Housing materials	housing: stainless steel 316L / 1.4404; active face: stainless steel 316L / 1.4404; lock nuts: stainless steel 316L / 1.4404; connector housing: PEI	
Installation		

Weight [kg]	0.032
-------------	-------

**Displays / operating elements**

Output status indication	LED	yellow (4 x 90°)
--------------------------	-----	------------------

**Electrical connection**

Connection	M12 connector; Gold-plated contacts
------------	-------------------------------------

**Wiring**

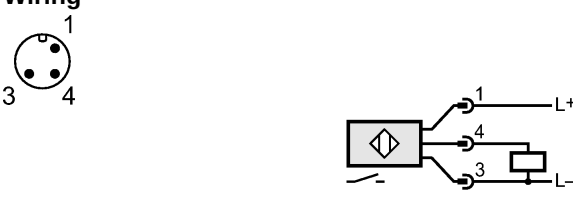

**Accessories**

Accessories (included)	2 lock nuts
------------------------	-------------

**Remarks**

Remarks	*) sensing face
---------	-----------------

Pack quantity [piece]	1
-----------------------	---